

THERMOSTATIC STEAM TRAPS

Balanced Pressure Design – CR25 Series

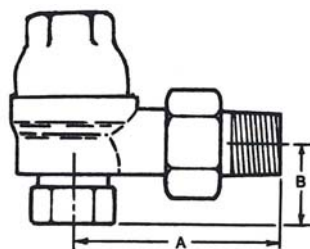

Model CR25A

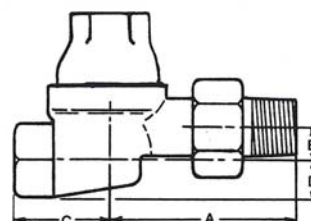

Model CR25S

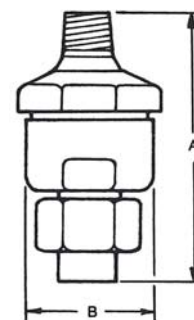

Model CR25V

FEATURES

- All working parts are factory calibrated and sealed to ensure optimum performance
- The sealed cartridge design allows for disassembly of the trap while the system is still hot
- Individually tested on steam for both cycle and leakage
- Working Pressure Range: 25" Hg vacuum to 25 psi

MATERIALS

Part	Description
Body	Bronze
Cap	Bronze
Element	Stainless Steel
Seat	Brass
Seat Gasket	Non-Asbestos Fiber

DIMENSIONS AND WEIGHTS

Size		Models	A		B		C		D		E		Weight	
mm	in		mm	in	mm	in	mm	in	mm	in	mm	in	kg	lbs
15	1/2	CR25A	73	2-7/8	32	1-1/4	—	—	—	—	—	—	.45	1
15	1/2	CR25S	70	2-3/4	—	—	44	1-3/4	14	9/16	13	1/2	.57	1-1/4
15	1/2	CR25V	111	4-3/8	51	2	—	—	—	—	—	—	.68	1-1/2
20	3/4	CR25A	79	3-1/8	32	1-1/4	—	—	—	—	—	—	.57	1-1/4
20	3/4	CR25S	83	3-1/4	—	—	48	1-7/8	22	7/8	13	1/2	.68	1-1/2

Size	Capacity (EDR) at differential pressure *						Capacity in pounds per hour of condensate at differential pressure **										
	3.4 kpa	1/2 psi	6.9 kpa	1 psi	10 kpa	1-1/2 psi	34 kpa	5 psi	69 kpa	10 psi	103 kpa	15 psi	138 kpa	20 psi	172 kpa	25 psi	
mm	in	kpa	psi	kpa	psi	kpa	psi	kpa	psi	kpa	psi	kpa	psi	kpa	psi	kpa	psi
15	1/2	120		165		200		320		490		610		940		1270	
20	3/4	232		325		400		710		1040		1260		1850		2450	

* Standard rating (1/4 lb. condensate per EDR) is based on 1/2 psi differential pressure.

** Capacities shown are at 10°F below saturated steam temperature and are the result of an extensive testing program conducted in accordance with ANSI/ASME PTC39.1-1980, Condensate Removal Devices For Steam Systems. Significantly greater capacities are realized when condensate temperatures are cooler than 10°F below saturation temperature

Colton has a policy of continuous product research and improvement and reserves the right to change design and specifications without notice.



Tel: 1-888-300-9155 Fax: 1-888-300-9160 www.COLTONIND.com info@coltonind.com